

QUICK START GUIDE

Docky explains it all!

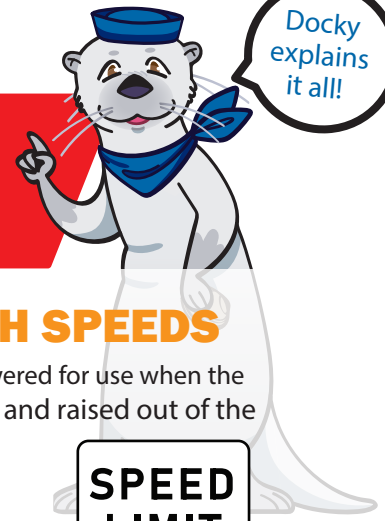

SAFETY MEASURES

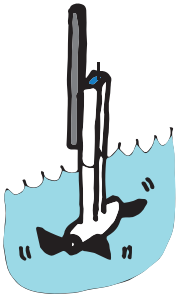

The Smart Thruster works **ONLY** when it is fully lowered on the mount. This Dockstar Safety Interlock System protects users from accidental operation.

When done, **remove** the Thruster from the mount, and **store**.

DO NOT USE AT HIGH SPEEDS

The Smart Thruster should only be lowered for use when the boat has slowed to less than **3 knots**, and raised out of the water before exceeding **3 knots**.



FACEPLATE

Attach the Antenna to the Antenna Connector when using the Thruster

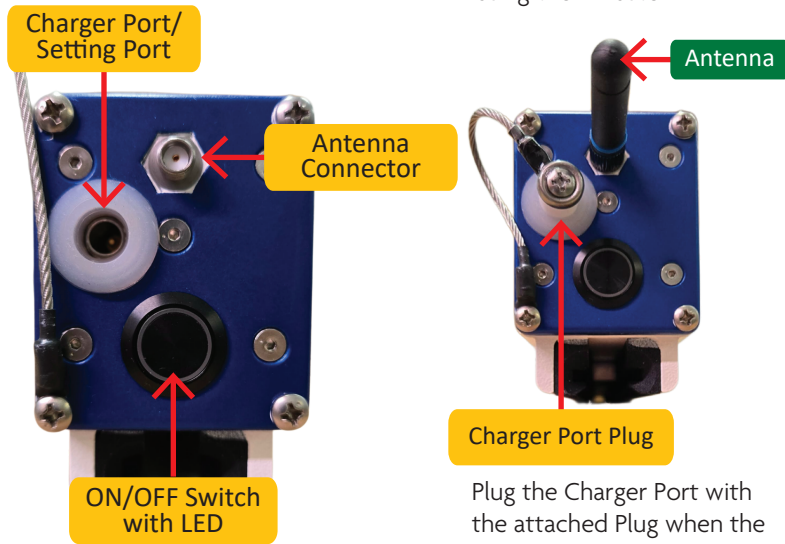

ON/OFF SWITCH

Press the ON/OFF Switch on the Faceplate to start or stop the Thruster. When the Switch is ON, the LED in the Switch flashes to show the status of the Thruster.

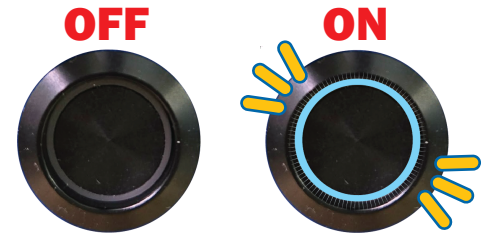

ROPE, HARNESS, PROPS

Lower and raise the Thruster on the mount by using the Rope.

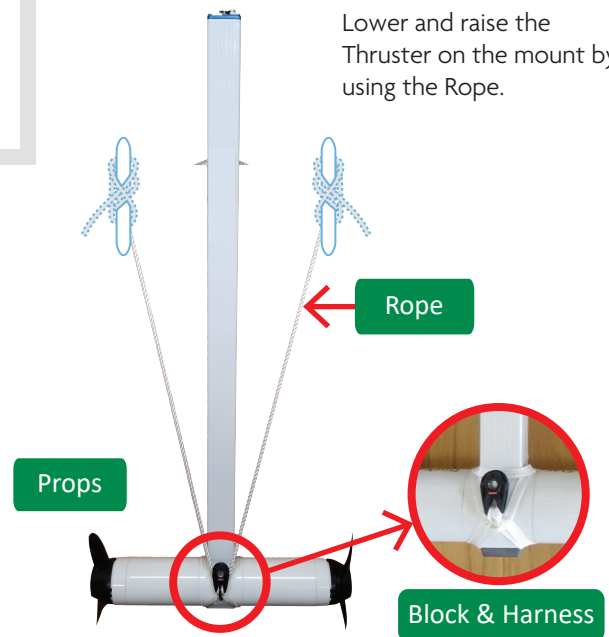

REMOTE CONTROL

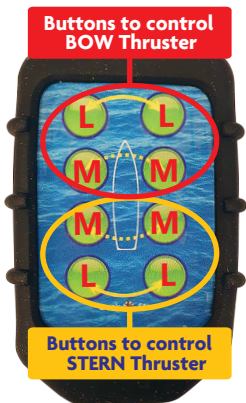

Momentary Button. The motors are turned on as long as the button is depressed.

Latching Button. The motors are turned on (and stay on for 30 sec) when the button is pushed. The latching can be terminated by pressing one of the Momentary Buttons.

FOR MORE INFORMATION





CHARGER PORT

- To charge the Thruster when the Battery Charger Plug is inserted.



- To pair the Thruster when the Pairing Plug is inserted.

TOP COVER

We include a water and UV proof cloth Top Cover. When not using the Thruster, protect the faceplate from corrosion and small debris.

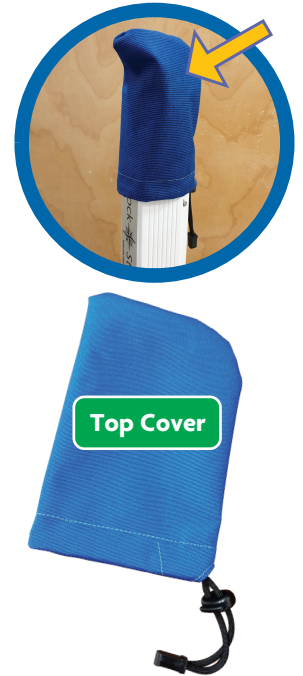

HOW TO CHARGE

Make sure to insert the Battery Charger Plug into the Charger Port **FULLY** and **TIGHTLY**.

Insert the Power Plug of the Battery Charger to a **110V** power source. The Thruster's ON/OFF Switch flashes when the Thruster is being charged.

Battery Charger's LED is **RED** when the Thruster is being charged. It becomes **GREEN** when the charging is done. A fully charged Thruster provides **10 minutes** of thrusting power.

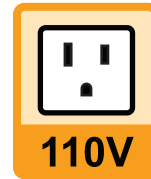

What does the LED flashing pattern on the ON/OFF Switch mean? The most common LED flashing patterns (repeat every 1.5 seconds)

THRUSTER STATUS	0.5 sec	1.0 sec	1.5 sec
Power Off or Sleeping			
Normal Operation: Battery Low		████████████████████	
Normal Operation: < 25% Charge Remaining	████████████████████	████████	████████
Normal Operation: 25%-50% Charge Remaining	████████████████████	████████	████████
Normal Operation: 50%-75% Charge Remaining	████████████████████	████████	████████
Normal Operation: > 75% Charge Remaining	████████████████████	████████	████████
Thruster Deployed, Ready to Operate	★	★	★
Charging < 25%		████████	
Charging 25%-50%		████████	████████
Charging 50%-75%		████████	████████
Charging 75%-100%		████████	████████
Charging Battery Nearly Full, Balancing	████████████████████	████████████████████	████████████████████
Charging Complete*	████████████████████	████████████████████	████████████████████

*After the "Charging Complete", the LED light stays on for two (2) hours.

***Please refer to User Manual for all other flashing patterns.**